

Order and Plan for A38 Birmingham Road/Birmingham Road Cul de sac, Bromsgrove

Statement of Reasons for proposing to make an Order under the Road Traffic Regulation Act 1984

WORCESTERSHIRE COUNTY COUNCIL (A38 BIRMINGHAM ROAD/BIRMINGHAM ROAD (CUL DE SAC), BROMSGROVE) (PROHIBITION OF RIGHT TURN) AND (40 MPH SPEED LIMIT) ORDER 2026

Worcestershire County Council have made this Order for avoiding danger to persons or other traffic using the roads or any other road or for preventing the likelihood of any such danger arising.

It is considered that that Order will contribute to the securing of the expeditious, safe and convenient movement of all traffic (including pedestrians) and will have no adverse effect on other considerations contained in S122 Road Traffic Regulation Act 1984.

THOMAS POLLOCK
Head of Commercial Law
Legal and Governance

County Hall
Spetchley Road
Worcester
WR5 2NP

The order under the Road Traffic Regulation Act 1984

WORCESTERSHIRE COUNTY COUNCIL (A38 BIRMINGHAM ROAD, BROMSGROVE) (40 MPH SPEED LIMIT) ORDER 2026

Worcestershire County Council in exercise of their powers under Section 84 of the Road Traffic Regulation Act 1984 (which said Act is herein after referred to as 'the Act of 1984') and Part IV of Schedule 9 to the Act of 1984 and all other powers them enabling in that behalf and after consultation with the Chief Officer of Police in accordance with Part III of Schedule 9 to the Act of 1984 hereby makes the following Order:-

1. That The Trunk Roads (40 M.P.H Speed Limit) (No.17) Order 1966 is hereby revoked in its entirety.
2. That The Trunk Roads (A38) (North of Marlbrook Crossroads) (40 MPH Speed Limit) Order 1988 is hereby revoked in its entirety.
3. No person shall drive or cause or permit to be driven any motor vehicle at a speed exceeding 40 miles per hour along that length of A38 Birmingham Road, Bromsgrove, from a point 78m north of its junction with U21425 Birmingham Road in a southerly direction to its junctions with A38 Lickey End Roundabout.
4. No speed limit imposed by this Order applies to vehicles falling within regulation 3(4) of the Road Traffic Exemptions (Special Forces) (Variation and Amendment) Regulations 2011 when used in accordance with regulation 3(5) of those regulations.
5. This Order may be cited as Worcestershire County Council (A38 Birmingham Road, Bromsgrove) (40 MPH Speed Limit) Order 2026 and shall come into operation on XXXX 2026.

Dated XXXXX 2026

The Common Seal of)
Worcestershire County Council was)
hereunto affixed in the presence of:-)

L.S.
Thomas Pollock
Assistant Director for
Legal and Governance

The order under the Road Traffic Regulation Act 1984

**WORCESTERSHIRE COUNTY COUNCIL
(A38 BIRMINGHAM ROAD/BIRMINGHAM ROAD (CUL-DE-SAC),
BROMSGROVE)
(PROHIBITION OF RIGHT TURN) ORDER 2026**

Worcester County Council in exercise of their powers under Sections 1 and 2 of the Road Traffic Regulation Act 1984 (which said Act is hereinafter referred to as “the Act of 1984”), and of all other powers them enabling in that behalf, and after consultation with the Chief Officer of Police in accordance with Part III of Schedule 9 to the said Act of 1984, hereby make the following Order:-

1. No person shall cause or permit any vehicle from turning right onto C2159 School Lane when driving in a northerly direction on A38 Birmingham Road, Bromsgrove.
2. No person shall cause or permit any vehicle from turning right onto the A38 Birmingham Road, Bromsgrove in a southerly direction from its junction with Birmingham Road (Cul-de-sac).
3. This Order shall come into operation on XXXXX 2026 and may be cited as Worcestershire County Council (A38 Birmingham Road /Birmingham Road (Cul-de-sac)) (Prohibition of Right Turn) Order 2026.

Dated: XXXXX 2026

The Common Seal of Worcestershire)
County Council was hereunto)
Affixed in the presence of:-)

L.S.
Thomas Pollock
Head of Commercial Law
Legal and Governance

Map and plan of the area

Map of A38 Birmingham Road and Birmingham Road (Cul De Sac), Bromsgrove and the proposed **40 mph speed limit** and the **prohibition of right turn** to be implemented by the above order

Description of the map

The map shows the proposed **40 mph speed limit** and the **prohibition of right turn** on A38 Birmingham Road and Birmingham Road (Cul De Sac), **Bromsgrove:**

Prohibition of right turn

Birmingham Road (Cul-de-sac): at a point 105 m south of its junction with A38 Lickey End roundabout.

A38 Birmingham Road (northbound): at its junction with C2159 School Lane.

40mph speed limit

A38 Birmingham Road: from a point 78m north of its junction with U21425 Birmingham Road in a southerly direction to its junction with the A38 Lickey End Roundabout.

A38 BREP Maps - Scheme F 02

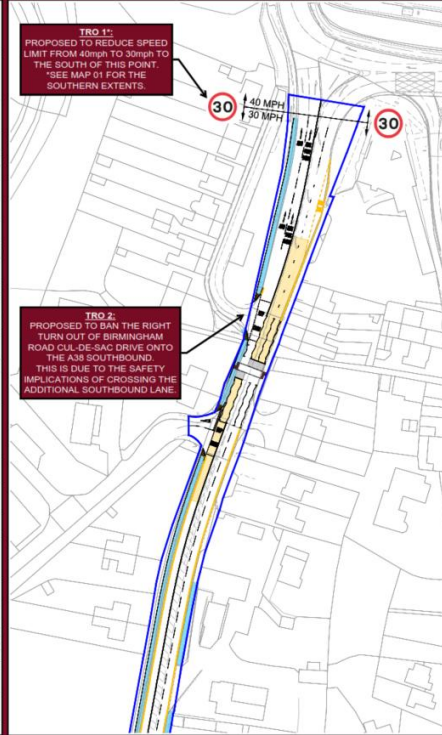
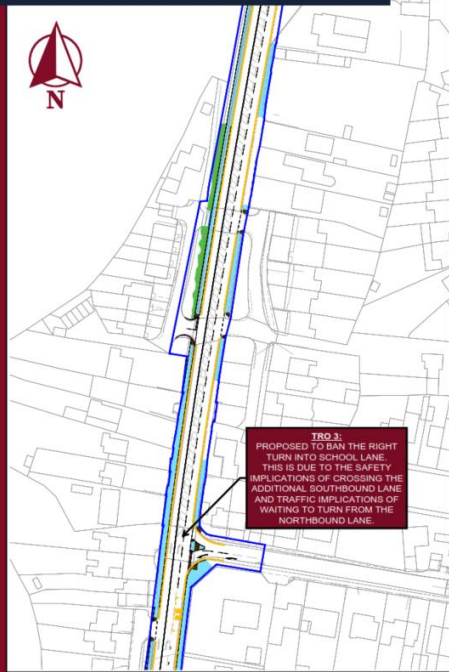

Legend

- Site Boundary
- Proposed Design
- Area of New Carriageway
- Area of New Footway/Cycleway
- High Friction Surfacing (Buff Colour)
- High Friction Surfacing (Black Colour)
- Tactile Paving (Red Colour)
- Tactile Paving (Buff Colour)
- Verge

DISCLAIMER:
This map is not to scale.
It is for illustrative purposes only.

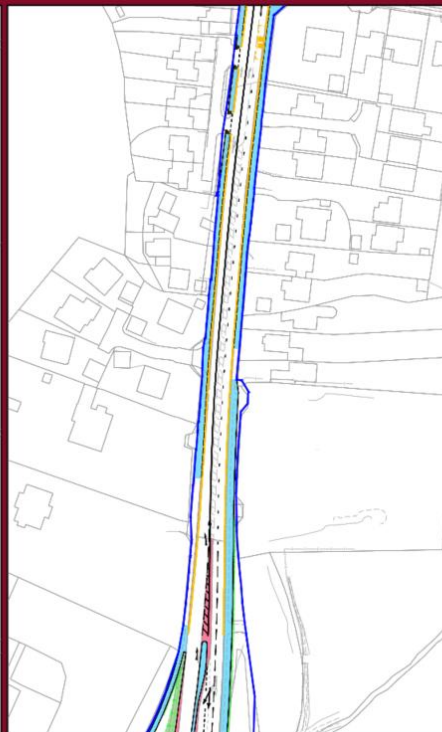
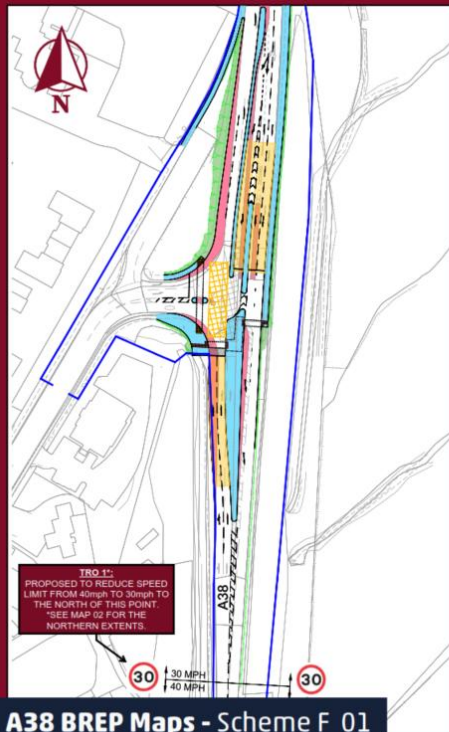

Legend

- Site Boundary
- Proposed Design
- Area of New Carriageway
- Area of New Footway/Cycleway
- High Friction Surfacing (Buff Colour)
- High Friction Surfacing (Black Colour)
- Tactile Paving (Red Colour)
- Tactile Paving (Buff Colour)
- Verge

DISCLAIMER:
This map is not to scale.
It is for illustrative purposes only.



A38 BREP Maps - Scheme F 01



SM

1428

STATUTORY INSTRUMENTS

1988 No.

ROAD TRAFFIC
THE TRUNK ROADS (A38) (NORTH OF MARLBROOK CROSSROADS)
(40 MPH SPEED LIMIT) ORDER 1988

Made 1988
Coming into force 1988

The Secretary of State for Transport in exercise of the powers conferred by section 84(1) and (2) of the Road Traffic Regulation Act 1984(a) and all other enabling powers hereby orders as follows:

1. This Order may be cited as the Trunk Roads (A38) (North of Marlbrook Crossroads) (40 mph Speed Limit) Order 1988, and shall come into force on 1988.
2. No person shall drive any motor vehicle at a speed exceeding 40 mph on the length of road specified in the Schedule to this Order.

Signed by the authority of
the Secretary of State
1988

N E FIRKINS
Deputy Director (Transport)
West Midlands Regional Office
Birmingham

SCHEDULE

That length of the A38 Trunk Road in the County of Hereford and Worcester which extends from a point 114.33 metres north of its junction with the B4185 at Marlbrook Crossroads to a point 80 metres north of its junction with Birmingham Road/Malesoven Road (a distance of 465.7 metres measured along the said length of road).

(a) 1988 n. 37

SMT (7551)



DEPARTMENT OF TRANSPORT

THE TRUNK ROADS (A38) (NORTH OF MARLBROOK CROSSROADS)
(40 MPH SPEED LIMIT) ORDER 19

STATEMENT OF REASONS

The proposal for a 40 mph speed limit north of the A38 Marlbrook Crossroads is justified due to the semi-urban nature of the road, the very high traffic flows and a high potential for accidents.

County Leicestershire



STATUTORY INSTRUMENTS

1966 No. 647

ROAD TRAFFIC

THE TRUNK ROADS (40 M.P.H. SPEED LIMIT) (NO. 17) ORDER 1966

MADE	25th May	1966
COMING INTO OPERATION	29th June	1966

The Minister of Transport in exercise of her powers under section 11(1) of the Road Traffic Act 1962(a) and of all other powers her enabling in that behalf hereby orders as follows:-

1. No person shall drive any motor vehicle at a speed exceeding 40 miles per hour on the length of road specified in the Schedule to this Order.
2. The Interpretation Act 1889(b) shall apply for the interpretation of this Order as it applies for the interpretation of an Act of Parliament.
3. This Order may be cited as "The Trunk Roads (40 m.p.h. Speed Limit) (No. 17) Order 1966" and shall come into operation on the 29th June 1966.

Given under the Official Seal of the Minister of Transport the
25th May 1966.

(L.S.)

J. S. CRUICK

An Under Secretary of the
Ministry of Transport

SCHEDULE

That length of the Exeter-Leeds Trunk Road (A.38), known as Birmingham Road in the Urban District of Bromsgrove in the County of Worcester, which extends from a point 270 yards north of its junction with Burcot Lane to a point 125 yards north of its junction with Brace Lane, a distance of approximately 2,880 yards.

(a) 10 & 11 Edw.2.c.59.

(b) 52 & 53 Vict.c.65.